

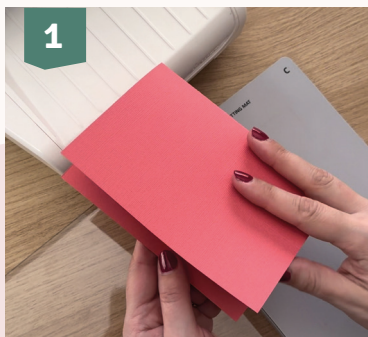

Making a shaker card for Valentine's Day

Create a fun Valentine's card with a shaker effect! Get started with the Vaessen Creative circle cutting dies and surprise someone with an original, handmade shaker card full of love.



1 Take a red A5 sheet and fold it in half. First, make a scoreline for a neat fold.



2 Use the Vaessen Creative circle cutting dies with stitched edge (3624-308). Number the dies from largest to smallest: no. 1 is the largest, and no. 8 the smallest. Place the folded card on the Cut Easy cutting plate and position die no. 1 on top. It won't fit entirely on the paper, but that's the idea!



3 Take a sheet of paper in a different colour and cut out a circle using die no. 2.

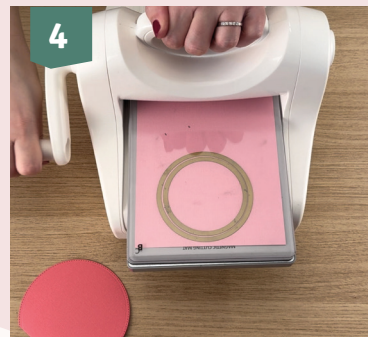

4 Choose another colour of paper and place dies no. 3 and no. 4 together, one inside the other. Align them properly and cut out. We will only use the cut-out ring later.

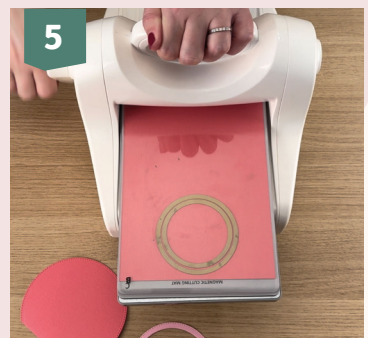

5 Now use the same colour as in step 1. Place dies no. 4 and no. 5 together, align them, and cut out. Again, we'll only use the ring.



6 Take a white sheet of paper and cut out a circle with die no. 3.



7 Place this white circle in the embossing folder and run it through the Cut Easy.

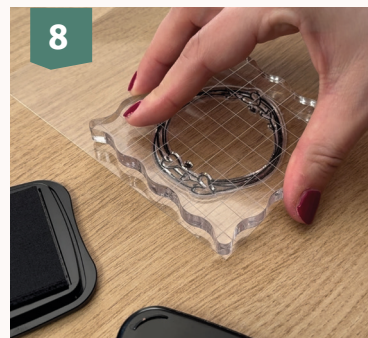

8 Take a sheet of acetate and stamp the round heart stamp on it using black StazOn ink. Let the ink dry well or use a heat tool.





9 Cut out the stamped image from the acetate sheet using circle die no. 4. If it doesn't cut through in one go, run it through the machine a few times.



10 Place the acetate circle and the circle rings from steps 4 and 5 upside down. If needed, tape the rings together first. Then glue the acetate circle onto the paper and let it dry thoroughly. Create a border around the acetate circle with foam tape, trimming it to size so it doesn't stick out.



11 Sprinkle shaker elements onto the acetate circle. Then remove the protective backing from the foam tape.



12 Stick the embossed circle on top of the foam tape to close the shaker.



13 Cut two narrow paper strips, about 3 mm wide. Apply 3 mm double-sided tape around the shaker and stick the strips on top. Trim any excess paper.



14 Now attach the circle from step 2 and the shaker onto the base card (as shown in the photo).



15 Turn the card over and neatly trim any edges that stick out.



16 Finally, write a sweet Valentine's message inside the card. Your card is now ready to surprise someone special!

