



## Christmas card with hanging stars

In this Christmas craft, we'll show you how to make your own Christmas card with a window and hanging paper stars. A creative design that's fun to make and a joy to send during the festive season.



Choose a selection of pretty sheets from the Let it Snow design paper pad. In this example, 5 different prints were used.



Take a dark green sheet and place two square cutting dies on top (4 x 4 inches / 10.2 x 10.2 cm and 4.5 x 4.5 inches / 11.4 x 11.4 cm, both with stitched edges). Position the smaller die inside the larger one and secure them with masking tape to prevent shifting.

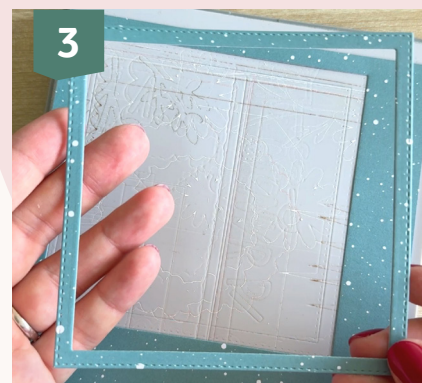

Run this through the embossing machine. You will now have a green frame, as shown in the photo.



Cut a piece of white cardstock measuring 10.6 x 5.3 inches (27 x 13.5 cm) and score down the middle of the long side. Fold in half to create a card measuring 5.3 x 5.3 inches (13.5 x 13.5 cm).



Place the 4 x 4 inches (10.2 x 10.2 cm) square die in the centre of the card front and run it through the embossing machine.

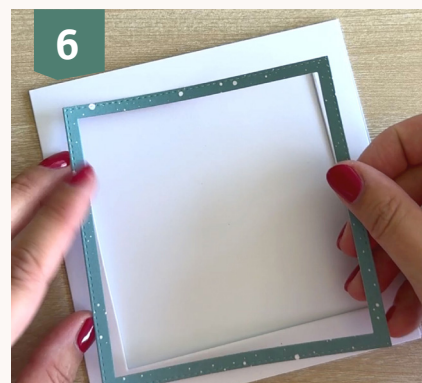

A window will now appear in the card. Adhere the green frame neatly over this opening.







From another piece of design paper, cut a square of 4,5 x 4,5 inch (11.4 x 11.4 cm) using the die and embossing machine.



Stick this square on the inside of the card, directly behind the window.



Optionally, stamp a Christmas greeting on this panel.



You can also add extra stamped designs, such as a reindeer or snowflakes.



Take the set of star punches and use the medium and small sizes. Punch out several stars in four different paper colours.



Note: for each star you will need two identical shapes (for the front and back).



Cut pieces of hemp cord, 5.1 inches (13 cm) long (in this example, 5 were used, but you can make more or fewer if you like).



Fix the twine pieces to the inside top of the window with masking tape and decide where the stars will hang.



Adhere a star on both sides of each piece of twine so they are secure and double-sided. Once everything is in place, glue the twine ends down and remove the masking tape.



16

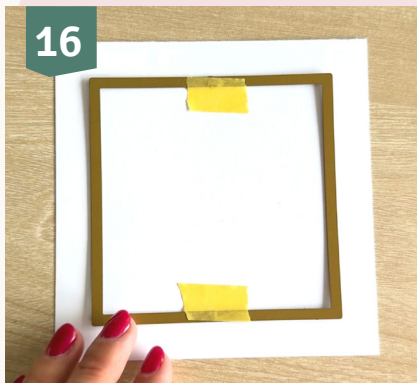

Cut another piece of white paper, 5.2 x 5.2 inches (13.2 x 13.2 cm), and use the 4 x 4 inches (10.2 x 10.2 cm) die to cut a window from the centre.

17



Stick this white frame to the inside of the card to neatly cover the ends of the cords.

