



Make a Card Organiser from Envelope Boxes

Create your own card organiser with the Score Easy. Perfect for keeping everything neat and tidy, while also adding a cheerful touch to your craft desk. Ideal for anyone who loves cardmaking and crafting.



1
Cut 4 sheets of cardstock to 10 x 10 inches (25.4 x 25.4 cm). These will make 4 envelope boxes measuring 6.5 x 4.3 x 1 inches (16.5 x 11 x 2.5 cm).



2
Follow the Score Easy instructions and score according to the measurements for the envelope box.

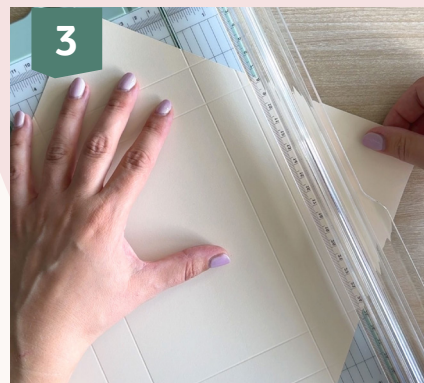

3
Place the scored paper in the paper trimmer and cut away the tip on the long side.



4
Punch the corners round or straight with the envelope punch.



5
Make small cuts on both sides of the paper (see example photo).



6
Fold the box into shape but do not glue yet. Mark with a pencil where the top flap meets the side flaps.





7 Draw a straight line between these marks and cut off the point.



8 Assemble all envelope boxes using glue or double-sided tape.



9 Cut one sheet of cardstock to 11.8 x 9.8 inches (30 x 25 cm). This will form the box to hold the envelope boxes.



10 Place the 11.8 inches (30 cm) side at the top and score at 1 inch, 2.5 inches, 9.2 inches and 10.8 inches (2.5 cm, 6.5 cm, 23.5 cm and 27.5 cm).



11 Rotate the paper a quarter turn (9.8 inches/25 cm side at the top) and score at 1 inch, 2.5 inches, 7.2 inches and 8.8 inches (2.5 cm, 6.5 cm, 18.5 cm and 22.5 cm). Draai het papier een kwartslag (25 cm boven) en ril op 2,5 cm, 6,5 cm, 18,5 cm en 22,5 cm.



12 Cut into the 9.8 inches (25 cm) sides as shown in the photo.



13 Crease all score lines firmly with a bone folder and apply double-sided tape to the inside of the flaps.

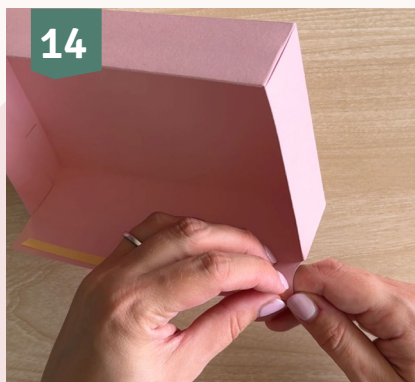

14 Assemble the box: first stick down the small flaps, then the long ones.



15 Cut 2 strips of cardstock measuring 1 x 11.8 inches (2.5 x 30 cm).





Use a border punch to punch a flower design along one edge of each strip.



Plak de tabjes op de bovenkant van de envelopdoosjes en plaats ze in het grote doosje. Nu heb je een handig opbergdoosje om al je kaartjes overzichtelijk te bewaren!



Fold the overhanging ends neatly around the sides. Attach the second strip so the pattern lines up, and continue until the box is fully covered.



Optionally, tie a satin ribbon around the box for extra decoration.



Punch 4 tabs from a piece of leftover cardstock.



Write a theme, size or label on each tab.



Adhere the tabs to the top of the envelope boxes and place them inside the large box. Now you have a practical and decorative organiser to keep all your cards neatly stored!

