



Create Christmas Cards with Nellie's Choice Shape Die

Get creative with the Nellie's Choice combo set, featuring a shape die and stencil in the form of a Christmas bauble. Add a touch of Astro Paste, design your own unique background, and voilà—your festive cards are ready to impress!



1 Take the Nellie's Choice Shape Die and two shades of blue paper. Use the Mini Cut Easy to cut out one bauble from each colour.



2 Take the centrepiece of the bauble and secure it to the back of the included stencil with washitape.

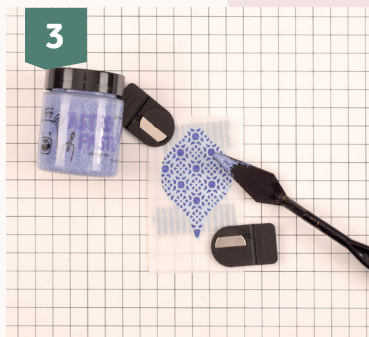

3 Attach the stencil to a work mat and spread Astro Paste evenly over it. Remove the stencil immediately and allow the paper to dry completely.



4 Use a sheet of white cardstock and stamp a background pattern using the Nellie's Choice background stamp.

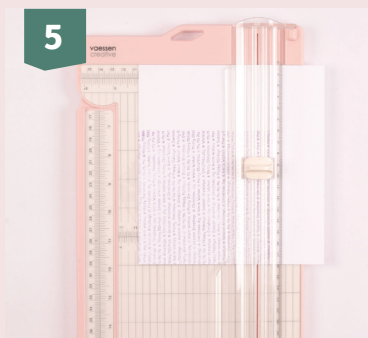

5 Once the ink is dry, cut rectangles measuring 6 x 10.5 cm from the stamped design.



6 From the same blue papers as the baubles, cut two card bases measuring 7 x 23 cm. Score them lengthwise at 11.5 cm to create folded cards.



7 Attach the stamped rectangles to the front of each card.



8 Assemble the baubles by switching the colours of the edges and centres (dark edge with light centre and vice versa). Glue the pieces together on the back and secure them to the cards with foam tape. Your handmade Christmas cards are finished!

