

A group of people are gathered at a social event, possibly a bar or restaurant. In the foreground, a man is aiming a shotgun. Behind him, several people are cheering with their arms raised. The scene is dimly lit with warm, ambient lighting. The background features a wooden bar and some greenery.

*experience*  
**OUR EVENTS**

**CLAYS**



**This is clay shooting,**  
*but not as you know it.*

**We've created an exciting**  
**virtual shooting experience**  
*set in beautiful venues.*

THE CITY • CANARY WHARF • SOHO • BIRMINGHAM

# *eat, DRINK SHOOT, dance + play.*

It all started with a game, but there's so much more to enjoy. From sharing charcuterie to partying on the dance floor, each part of the journey is designed to bring people together and create space for connection.



TAILORED PACKAGES TO SUIT EVERY GROUP



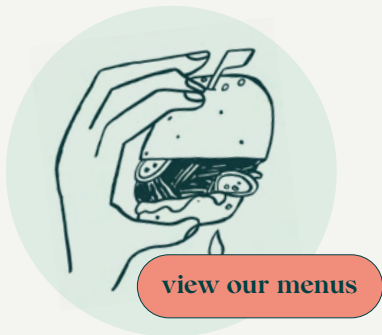

## Eat

Our premium menu, created by Culinary Director Roger Olsson, boasts sustainably sourced British produce bursting with fresh, regional flavours.



## Drink

Elevate your senses with premium drinks inspired by the flavours of the British countryside. More than a drink, it's an extraordinary experience.



## Shoot

Whether you're a first time shooter or seasoned pro, our diverse range of games promises something fun for everyone.



## Dance

Keep the party going for longer with unique spaces and entertainment that make your event truly unforgettable.





# AN UNFORGETTABLE EXPERIENCE

Our attentive events team are on hand  
to help you create an event to remember.



**Unlimited  
game play**



**Food & drink  
options**



**Private or  
semi-private**

## SEASONAL



Throw a Christmas or Summer party that'll go down in the history books, tailored to suit your teams.



## SOCIAL

Take your team building to the next level with engaging experiences in a fun and accessible format.

## MEETING



Bespoke to your business needs, we can provide cutting-edge tech and delicious refreshments to transform your next meeting or conference.



## NETWORKING

Switch up cocktail hour for the better with inclusive spaces designed to help people really get to know each other.

## CLIENT



Our private shooting rooms and dedicated pegs create a discrete environment for exclusive entertaining.





# *The* **CITY**

Our city venue has twelve beautiful semi-private pegs, and a spectacular private shooting room which allows plenty of space for playing, eating, drinking and celebrating.

**THE CITY, 55 MOORGATE,  
LONDON, EC2R 6LL**

**Nearest Station:**  
Moorgate, 3 minute walk

**View a 3D tour**



# The CITY

VENUE

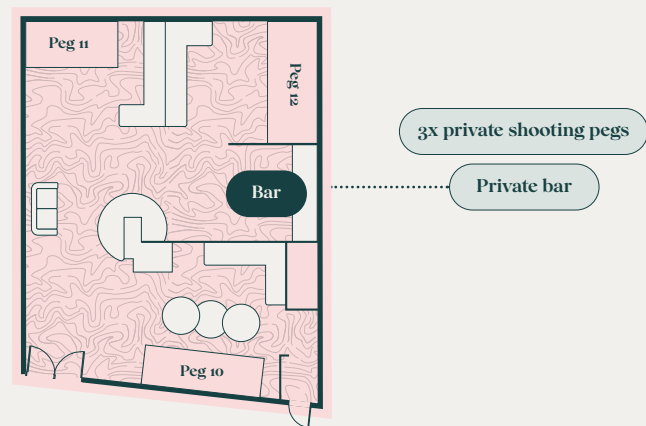
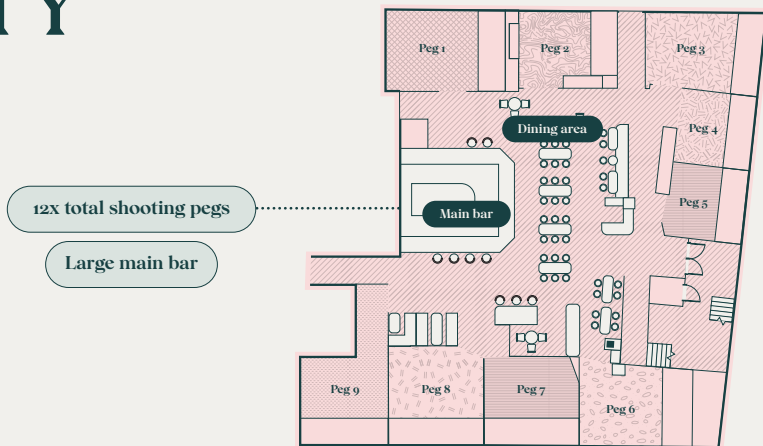

Situated a floor  
above the main  
venue

## Main floor exclusive

MAX. 300 GUESTS

9x shooting pegs

2x bars

Ideal for exclusive events

## Semi exclusive

MAX. 200 GUESTS

5x shooting pegs

Space at the main bar

Ideal for large events  
& team socials

## Private pegs

MIN. 15 GUESTS

1-3 shooting pegs

Space at the main bar

Ideal for small groups

## Private shooting room

MAX. 100 GUESTS

3x shooting pegs

Private bar

Large entertainment area

Ideal for large events  
& team socials



# The CITY

ULTRA PRIVATE  
SHOOTING  
ROOM

4-player shooting peg

Maxi bar

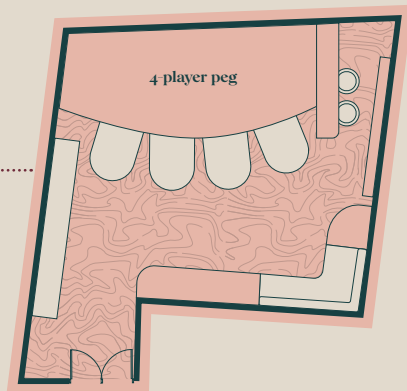

Situated a floor  
above the main  
venue

## THE HIDE

MAX. 30 GUESTS

4-player shooting peg  
Maxi bar

Ideal for smaller events  
& intimate gatherings

Looking for an ultra-premium experience?

Find out more.



A wide-angle photograph of the interior of a modern pub. The space is characterized by extensive wood paneling on the walls and floors. Large, leafy trees are suspended from the ceiling, creating a naturalistic atmosphere. Warm, ambient lighting is provided by small, round pendant lights. In the foreground, there's a bar area with red cushioned stools. A digital screen on the left displays a 'Reload' message. The overall design is contemporary and cozy.

# Canary WHARF

Perfectly located on the Wharf, this venue hosts eight spacious pegs and two bars. Our two outdoor heated terraces offer additional space for socialising with stunning views across the Thames.

ONE CABOT SQUARE,  
LONDON, E14 4QJ

Nearest Station:  
Canary Wharf, 4 minute walk



[View a 3D tour](#)



# Canary WHARF

VENUE

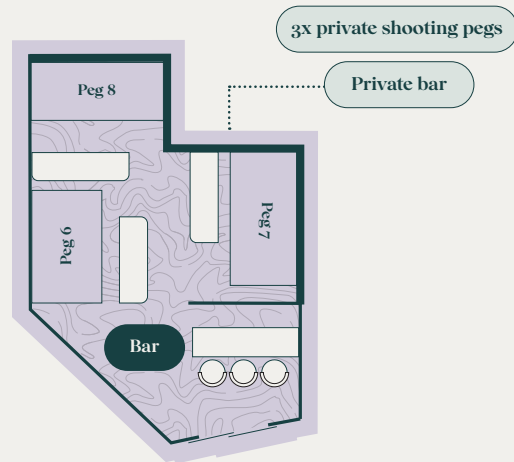
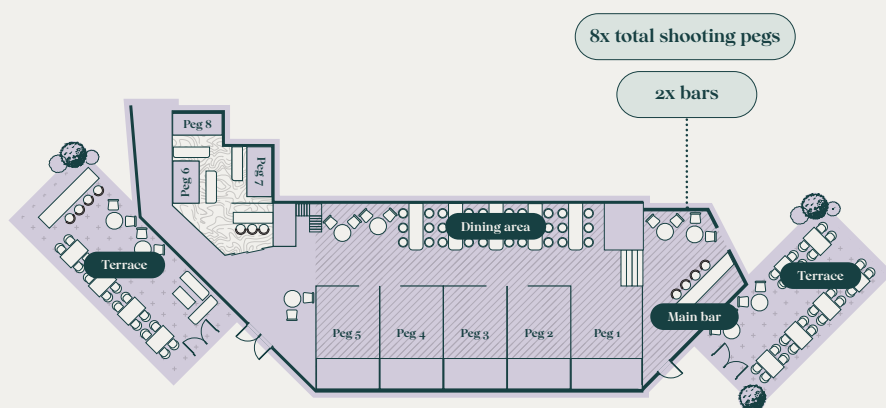

## Venue exclusive

MAX. 300 GUESTS

8 x shooting pegs

2 x bars

Ideal for exclusive events

## Semi exclusive

MAX. 200 GUESTS

5 x shooting pegs

Space at the main bar

Ideal for large events  
& team socials

## Private pegs

MIN. 15 GUESTS

1-3 shooting pegs

Space at the main bar

Ideal for small groups

## Private shooting room

MAX. 50 GUESTS

3 x shooting pegs

Private bar

Ideal for team socials

Outdoor terraces can be added to private hires to increase capacity



# *Introducing* Clays Soho

Clays Soho is the jewel in the Clays crown. With its sumptuous, original 1930s Art Deco interiors, in the heart of Soho, it oozes glamour and decadence. A window on another world.

All of the usual elements are here. The first-class food. The exceptional service. Those famous clarified cocktails. And, of course, the clays – with our classic pegs, Clay's Arcade, private room and our ultra premium private space, The Hide.

The best of Clays, made even better.



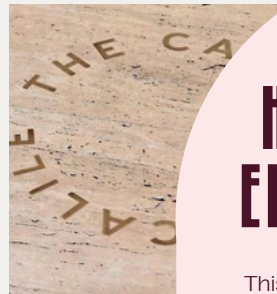
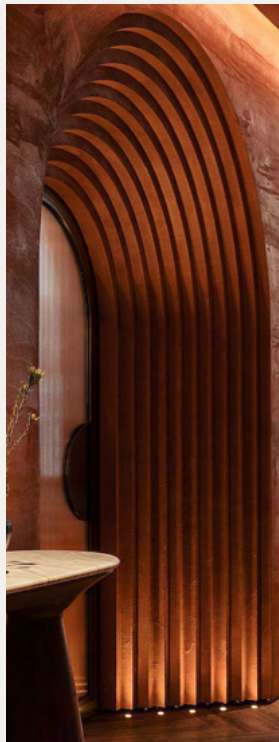
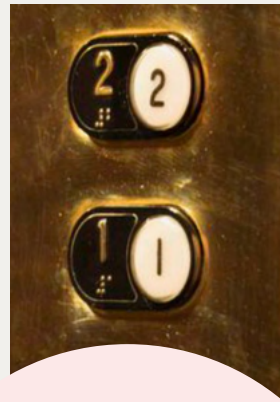
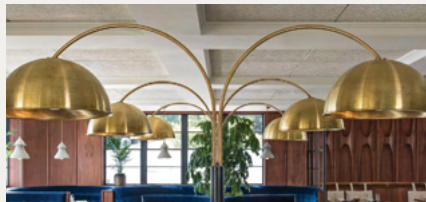
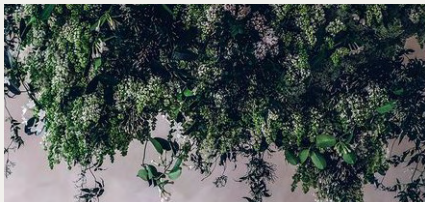

SOHO'S NEW  
**HOUSE OF  
ENTERTAINMENT**

This moodboard offers an exclusive first glimpse into the show-stopping, immersive and utterly unforgettable House of Entertainment, coming to life soon in Soho.

77 BREWER STREET  
LONDON, W1F 9ZN

Nearest Station:  
Piccadilly Circus, 3 minute walk

# SOHO

## VENUE

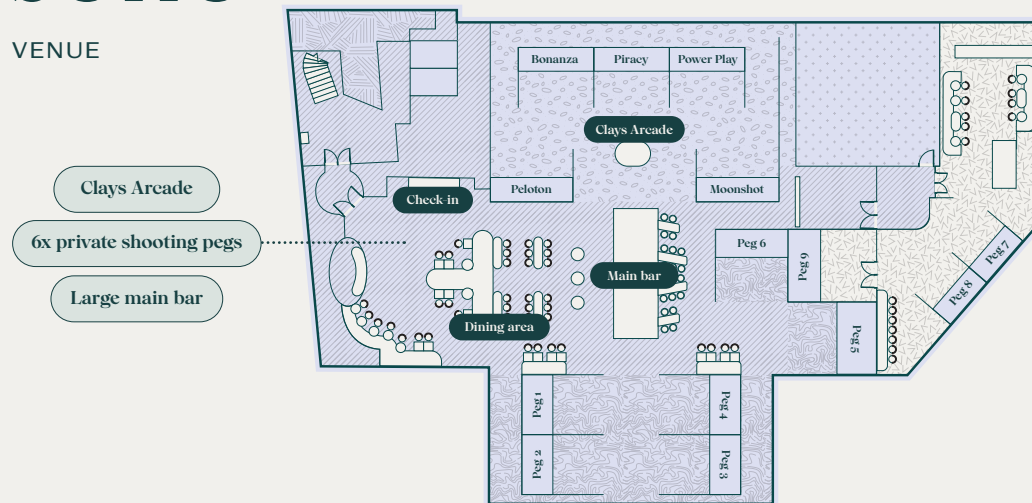

Clays Arcade

6x private shooting pegs

Large main bar

### Clays Arcade

MAX. 50 GUESTS

5 x game areas

Arcade bar

Ideal for small groups or semi exclusive events

### Private pegs

MIN. 15 GUESTS

1-4 shooting pegs

6x games to play

Ideal for groups

### Dining area

Table reservation available with packages

Space available for walk-ins.  
*Subject to availability.*

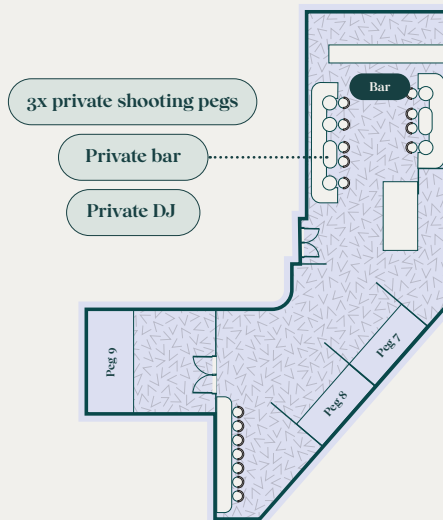

3x private shooting pegs

Private bar

Private DJ

### Private shooting room

MAX. 100 GUESTS

3x shooting pegs

Private bar

Large entertainment area

Ideal for large events & team socials

# SOHO

ULTRA PRIVATE  
SHOOTING  
ROOM

4 player shooting peg

Maxi bar

4 player peg

Situated a floor  
above the main  
venue

## THE HIDE

MAX. 35 GUESTS

4-player shooting peg  
Maxi bar

Ideal for smaller events  
& intimate gatherings

Looking for an ultra-premium experience?

Find out more.





## A NEW WAY TO CLAY

Clays Arcade delivers a social gaming experience like no other! Choose from five games, challenge up to four other players, and enjoy two turns per game to showcase your skills.







# CLAYS ARCADE

## WHAT IS CLAYS ARCADE?

Clays Arcade is a shared gaming space, perfect for smaller groups and socialising with friends.

## HOW MANY GAMES CAN I PLAY?

There are five different games, and each player will get to play two rounds of each game.

## WHAT IS THE DIFFERENCE BETWEEN THE ARCADE AND PEGS?

Clays Arcade is a shared gaming space for up to five players per game, perfect for a lively and social experience. Pegs are semi-private areas designed for larger groups of 15 or more, offering a more exclusive setting.

## WILL I BE PLAYING WITH OTHER GUESTS?

Yes, the Arcade is a shared space, so there will be other groups of guests in the area.

## CAN I ORDER FOOD AND DRINK IN THE ARCADE?

Guests are welcome to take their drinks from the main bar into the Arcade area to enjoy while playing. Please note that food cannot be ordered or consumed in the Arcade; instead, guests are encouraged to order and enjoy food in the dining area.

# GIVE US YOUR BEST SHOT

Suitable for all skill levels, our bespoke games can be played in teams or head to head.



## Bonanza

Make every shot count, collecting precious gems for every shot.



## Peloton

Pedal your way to victory: the more clays you hit, the faster you'll go.

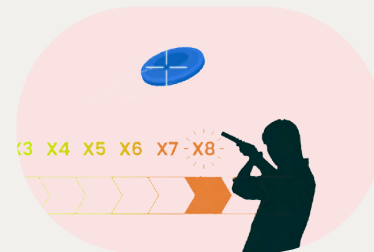

## Power Play

Precision is key: take aim and shoot accurately to make your hit.

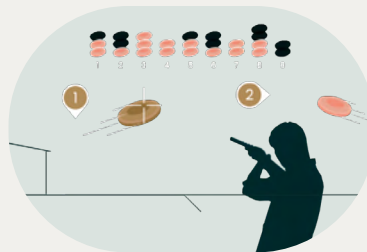

## Olympic Skeet

Enter the Olympic arena and move through eight immersive shooting stations, experiencing the thrill of the game in the city. Available for peg bookings only.

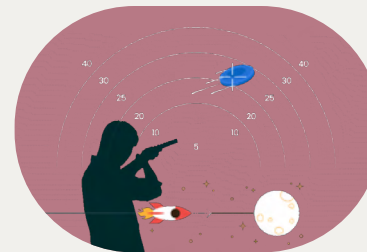

## Moonshot

Shoot for the stars: the further the distance the clay is hit, the higher the points.



## Piracy

Stay sharp: hit the clays wisely to avoid sinking to last place.



[View our menus](#)

# SAVOUR, *the moment*



When it comes to food, we're all about quality ingredients. Think British-grown vegetables, shore-to-door fish and slow-reared free-range meat for a fuller taste. Sustainably and ethically sourced, our sharing dishes are designed to be elevated with premium cocktails and crafted drinks. Smooth textures meet complex flavours, drawing together the flavours of the British countryside. The result? A sensory experience like no other.

We cater for all dietary requirements, including vegan, vegetarian and gluten-free.

LONDON EXPERIENCES

## Social

\*OFF-PEAK ONLY, EXCLUDES  
5-8PM WED & THURS

£38/*pp*

90 mins

Unlimited Gameplay

Nibbles Menu

2x Clays  
Drinks Coins

## Bronze

£56/*pp*

90 mins

Unlimited Gameplay

Events Menu

3x Clays  
Drinks Coins

## Silver

£76/*pp*

2 hrs

Unlimited Gameplay

Events Menu

Free Flowing  
Premium Drinks

Welcome Drinks

## Gold

£96/*pp*

3 hrs

Unlimited Gameplay

Premium Events Menu

Free Flowing  
Premium Drinks

Welcome Drinks

Winners Prizes

## Diamond

£116/*pp*

4 hrs

Unlimited Gameplay

Premium Events Menu

Free Flowing  
Premium Drinks

Welcome Drinks

Winners Prizes

Personal Welcome  
Message On Screen

Speak to a member of our team



View our menus

EVENT EXPERIENCES REQUIRE A MINIMUM OF 15 GUESTS PER GROUP.  
WE ADD AN ADDITIONAL 12.5% DISCRETIONARY SERVICE CHARGE TO EACH BOOKING.



- Games Master
- DJ
- VJ's
- GB Olympic athlete
- On-screen branding
- Bespoke entertainment



# *elevate your* **EVENT**

Take your event to the next level with a selection of bespoke extras.

Our 4k digital screens are perfect for branding your experience or using to present to your team.





# CLAYS WINNERS PRIZES

Raise the stakes and add prizes to your booking, available from £50.

[Find out more](#)

**Don't forget about  
*the rookies!***



No losers here! **Last place** wins a **£50 training voucher** to come back to Clays and practice those aiming skills.



**Book now**

Quick response times

Dedicated account manager

Tailored advice for your event

**CLAYS**